

# Roof Coverage Rates

## Recommended Coverage Guideline

### For Nu-Flex, TileFlex 2000®, ColourFast and Nutech Primer Systems

The recommended coverage is 4 square metres per litre per coat. Three coats are normally required comprising, one coat of primer/sealer and two coats of top coat.

The following table is recommended for the following products; Accopol 847®, Asbestos Primer, Master Sealer, Nu-Prime, ColourFast, Nu-Flex, TileFlex 2000®, GP Primer, Insulguard, Flexible Membrane and Anti-Corrosion Metal Primer.

House Squares	Square Metres	Litres Required Per Coat	Number of 20 LT Drums Required Per Coat
8	93.60	23.40	1 ¼ drums
9	105.30	26.33	1 ½ drums
10	117.00	29.25	1 ½ drums
11	128.70	32.18	2 drums
12	140.40	35.10	2 drums
13	152.10	38.03	2 drums
14	163.80	40.95	2 drums
15	175.50	43.88	2 ¼ drums
16	187.20	46.80	2 ½ drums
17	198.90	49.73	2 ½ drums
18	210.60	52.65	3 drums
19	222.30	55.58	3 drums
20	234.00	58.50	3 drums
21	245.70	61.43	3 ¼ drums
22	257.40	64.35	3 ½ drums
23	269.10	67.28	3 ½ drums
24	280.80	70.20	3 ½ drums
25	292.50	73.13	4 drums
26	304.20	76.05	4 drums
27	315.90	78.98	4 drums
28	327.60	81.90	4 ¼ drums
29	339.30	84.83	4 ½ drums
30	351.00	87.75	4 ½ drums
31	362.70	90.98	4 ½ drums
32	374.40	93.60	5 drums
33	386.10	96.53	5 drums
34	397.30	99.45	5 drums
35	409.50	102.37	5 ¼ drums

## Roof Plan

Roof Area = Width in metres (a) x Length in metres (b)

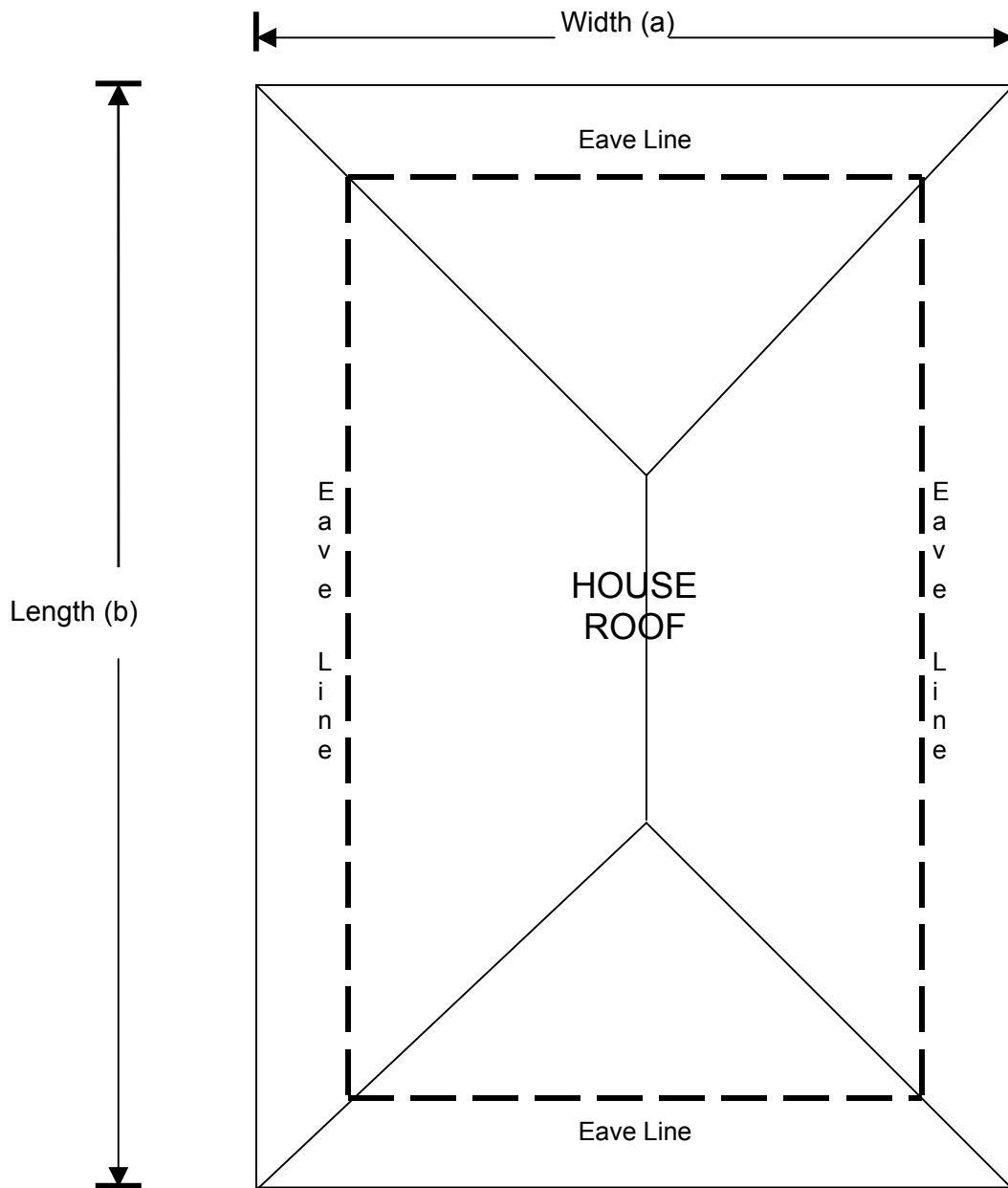

**Note:** This allows for a standard 21 degree roof pitch.

### Important Note

The information given on this data sheet is based on many years experience and is correct to the best of our knowledge. However since the use of our product, surface conditions, weather and a number of other factors are completely beyond our control, we can only be responsible for the quality of our product at the time of dispatch. For more information please contact our Company. As this information is of a general nature, we cannot assume any responsibility in individual cases.